

POLE BRACING DETAIL

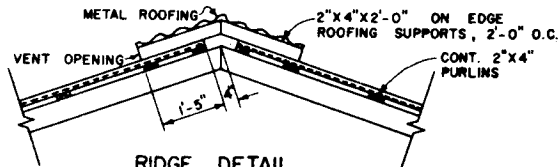

RIDGE DETAIL

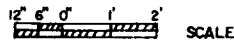
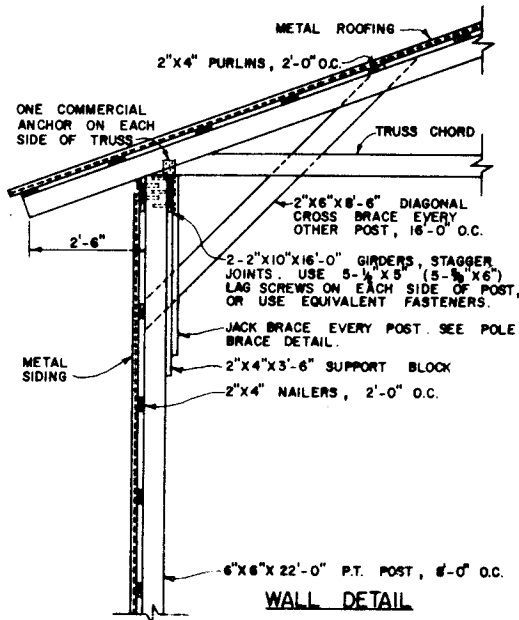
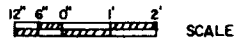

WALL DETAIL

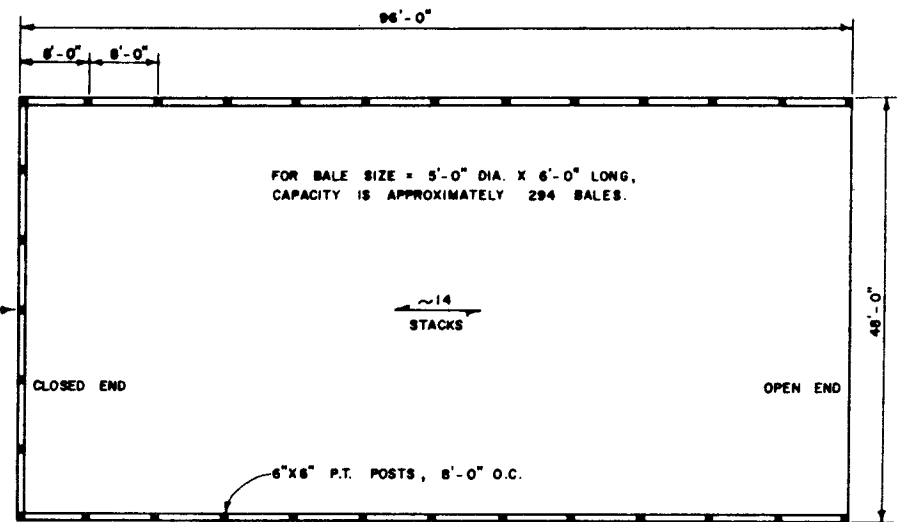
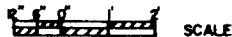

PLAN

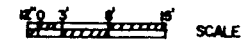

NOTES:

1. P.T. = PRESSURE TREATED. TREAT TO A PRESERVATION RETENSION OF 5-7 POUNDS PER CUBIC FOOT AS PER A.W.P.A. STANDARDS.
2. BALES WILL SETTLE AND SPREAD. ALLOW 4"-5" ON ALL SIDES OF EACH BALE WHEN PLANNING STORAGE.
3. SELECT TRUSS THAT SUPPORTS SNOW AND WIND LOADS FOR YOUR AREA. SPACE TRUSSES 4 O.C. (2 O.C.). DESIGN SHOWN IS FOR A 20 LBS. PER SQ. FT. SNOW LOAD. FIGURES IN () INDICATE REQUIREMENTS FOR A 30 LBS. PER SQ. FT. SNOW LOAD.

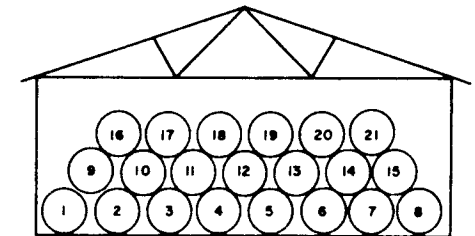

STACKING DIAGRAM

(21 BALES, 5' DIAMETER)

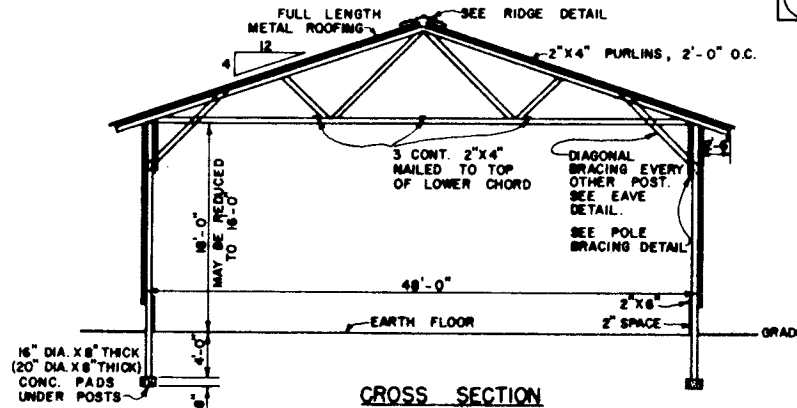

CROSS SECTION



COOPERATIVE EXTENSION WORK IN AGRICULTURE AND HOME ECONOMICS

732-6350

UNITED STATES DEPARTMENT OF AGRICULTURE COOPERATING

MAY STORAGE FOR LARGE ROUND BALES

TN '80 EX. 6350 SHEET 1 OF 1